

ISTEC®

SHOWERS & EYEBATHS

Our new ISTEC® Type BIO Human Disinfection / Sanitizing Decontamination Misting Shower which has been launched by IST Safety Ltd to support your COVID-19 precautions in May, 2020 provides an effective sanitation during removal of the PPEs in workplaces and helps to reduce bacterial and viral infection risks of human by installing in public areas such as entrance of malls, buildings, hospitals etc.

The system operates automatically by its sensors without having touched when the user enters inside the tunnel.

Decontamination continues for 10 seconds. After a 10-second operating time, the spray nozzles stop spraying and the user leaves the tunnel.

With its standard 100L, 316SS tank which filled with water and %1 disinfectant solution, the unit provides 250 minutes decontamination in total that means 1500 users to be sanitize, based on 10 seconds per person.

The unit's main advantage is less water consumption during decontamination thanks to its special nozzles which mists the water.

Another advantage of the unit is that its modular structure that can be customized on design with its wide range of standard and optional accessories. We offer high quality portable or fixed type systems.

All our products are guaranteed against production and workmanship defects for a period of 24 months.



Frame Material		Aluminium Sigma Profile	Steel Profile
Side Cabin Panels (Standard)		Polycarbonate	Polycarbonate
Accessories	Spray Nozzles	8 Pieces	8 Pieces
	Water Hose	10 mm Polyamide	10 mm Polyamide
Disinfection	Pump	70-120 bar - 2 l/min	70-120 bar - 2 l/min
	Water Tank	40 L 316SS or 100 L Plastic	40 L 316SS or 100 L Plastic
Accessories of pump and water tank room		Water level indicator and junction box	
Dimensions (WxLxH)		100x100x210 cm	100x100x210 cm
Electrical Power Supply		220V 50 Hz	220V 50 Hz

Weight of the cabinet is 25 kgs

Weight of the water tank and pump room is 52 kgs

Disinfectants are provided by the end-user.

Our company does not accept responsibility for the chemicals to be used.



www.ist.com.tr

DISINFECTION MISTING SHOWER

ISTEC® TYPE BIO

ISTEC®

SHOWERS & EYEBATHS

OPTIONAL ACCESSORIES



- 1 Disinfectant Options*: Hydrogen Peroxide & Colloidal Silver & Chlorinated Water
- 2 Frame Material Options: Aluminium Sigma & Steel
- 3 Floor Options: Empty & GRP Grating & Carpet
- 4 Side Cabin Panel Options: Polycarbonate & Galvanized and Painted Steel & Stainless Steel & GRP
- 5 Water Tank Options: 316 Stainless Steel 40 L & Plastic 100 L
- 6 PVC curtain at the entrance and exit of the tunnel
- 7 Internal lighting with proximity switch
- 8 Junction box
- 9 White GRP sun canopy
- 10 Special labelling on demand

PLEASE ASK FOR YOUR
SPECIAL REQUIREMENTS

*Disinfectant products to be used in this product may harm human eyes and skin.
These disinfectant chemicals must be mixed with water at certain rates that will not harm human health.
Using of the disinfectant chemicals should be determined in accordance with the disinfectant manufacturers' instructions and MSDS.
Our company cannot be held responsible for the problems that may arise from uncorrect use of products.

*Photos of the optional accessories are shown as example. Actual items may appear differently.



www.ist.com.tr

TECHNICAL DRAWING

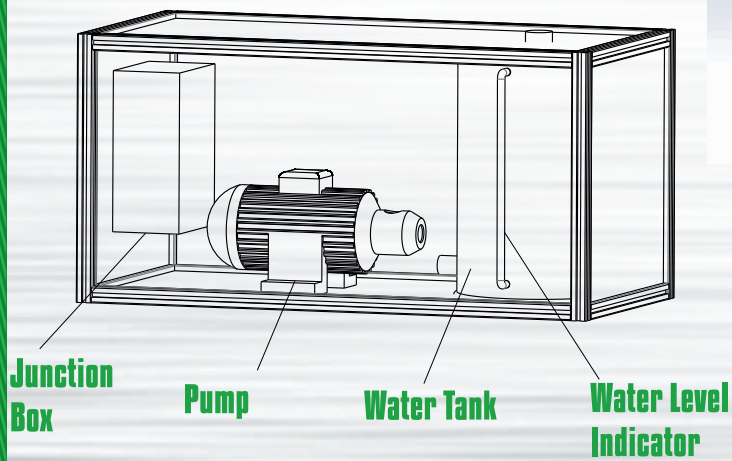
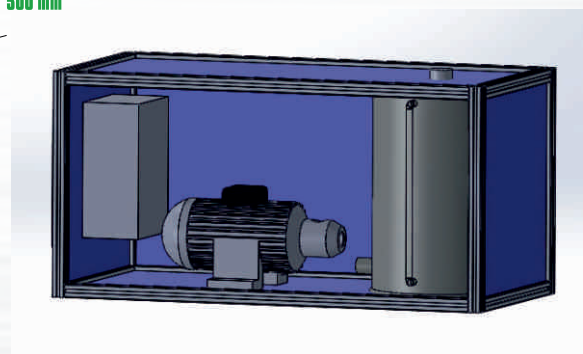
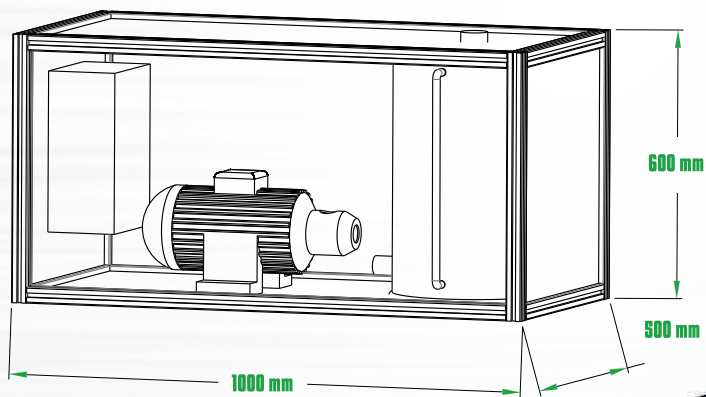
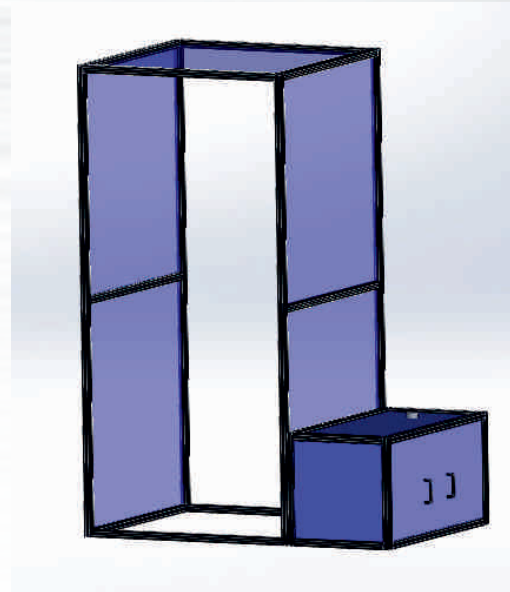
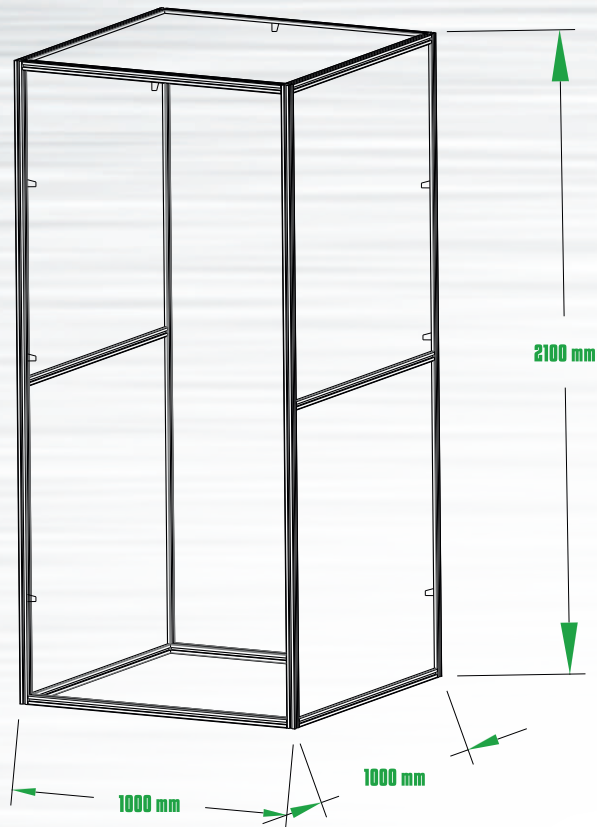

ISTEC®

SHOWERS & EYEBATHS

We provide variety of special services you may need.

Engineering Consultation

IST provides complete information on the design, use, supply and care of emergency showers and eye/face washes & decontamination units & disinfection tunnels.

For all your needs during a new plant installation or facility renovation, our experienced team will guide you to the best and most economical solution.

Quality and Safe Product Selection

Our product range has a wide range of standard and optional designs. For interior and exterior applications, we offer high quality systems with heating or cooling, with freeze protection, portable or fixed special systems.

Special Engineering Solutions

Each unit is designed for different purposes and cannot substitute each other. In addition, standardized units with heating or cooling, may not always be the right choice for your needs. IST is fully equipped to offer and produce the special designed systems according to your needs.

Adjusting Water Temperature

Tepid water supply (16 - 38 ° C), which is a requirement of both American and European standards, requires special attention. Our expert team has the capability to analyze resources of your facility and offer solutions to ensure that emergency showers and eye / face wash fountains will work properly under all circumstances.

Our experts will work in coordination with your design or expert team.

Pre-Sales Solid Modelling and Technical Drawing

We provide customized design and engineering solutions to customers with our advanced three-dimensional solid modelling software. In this way, our customers can more easily analyze the suitability of the product to their facility and can plan the project accordingly.

Two or three dimensional detailed technical drawings are available for all our products.

After-Sales Support

Our expert technicians can evaluate your existing systems to ensure compliance with ANSI and EN Standards.

Our expert team will assist you about training and product setup for your new unit. All our products are guaranteed against production and workmanship defects for a period of 24 months.

WHAT WE DO

📍 Ostim Mah. İvedik OSB 31.Cad. 2269.Sk. No: 42 • 06374 Yenimahalle, Ankara, TURKEY

☎ +90 312 384 13 00

☎ +90 312 341 73 03



✉ info@ist.com.tr

🌐 www.ist.com.tr